

How to identify the various types of roof bar mounting rail systems.

Traditional Roof Rails

The Standard Roof Rail has a gap between the bar and the roof that you can put your hand through. There are normal and wide bars but both operate the same. Cross bars may clamp to the rails either side to side or top and bottom. Very common on older car models but in the pursuit of aerodynamic efficiency is largely being replaced by the Flush Rail system on many newer cars.

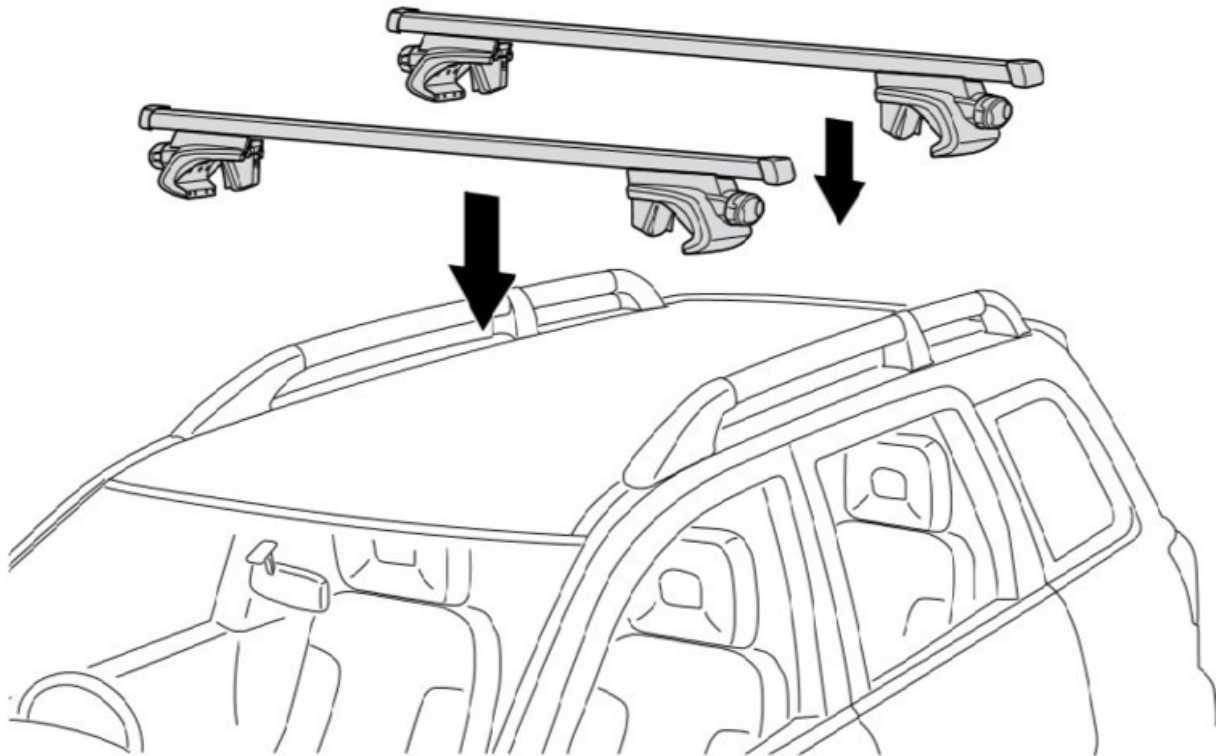

Flush Rails

Flush Rails sit above the roof line but are solid and have no gap underneath them. The profiles vary on make and model and require different fittings for almost every vehicle. All cross bars clamp side to side using ridges in the profile.

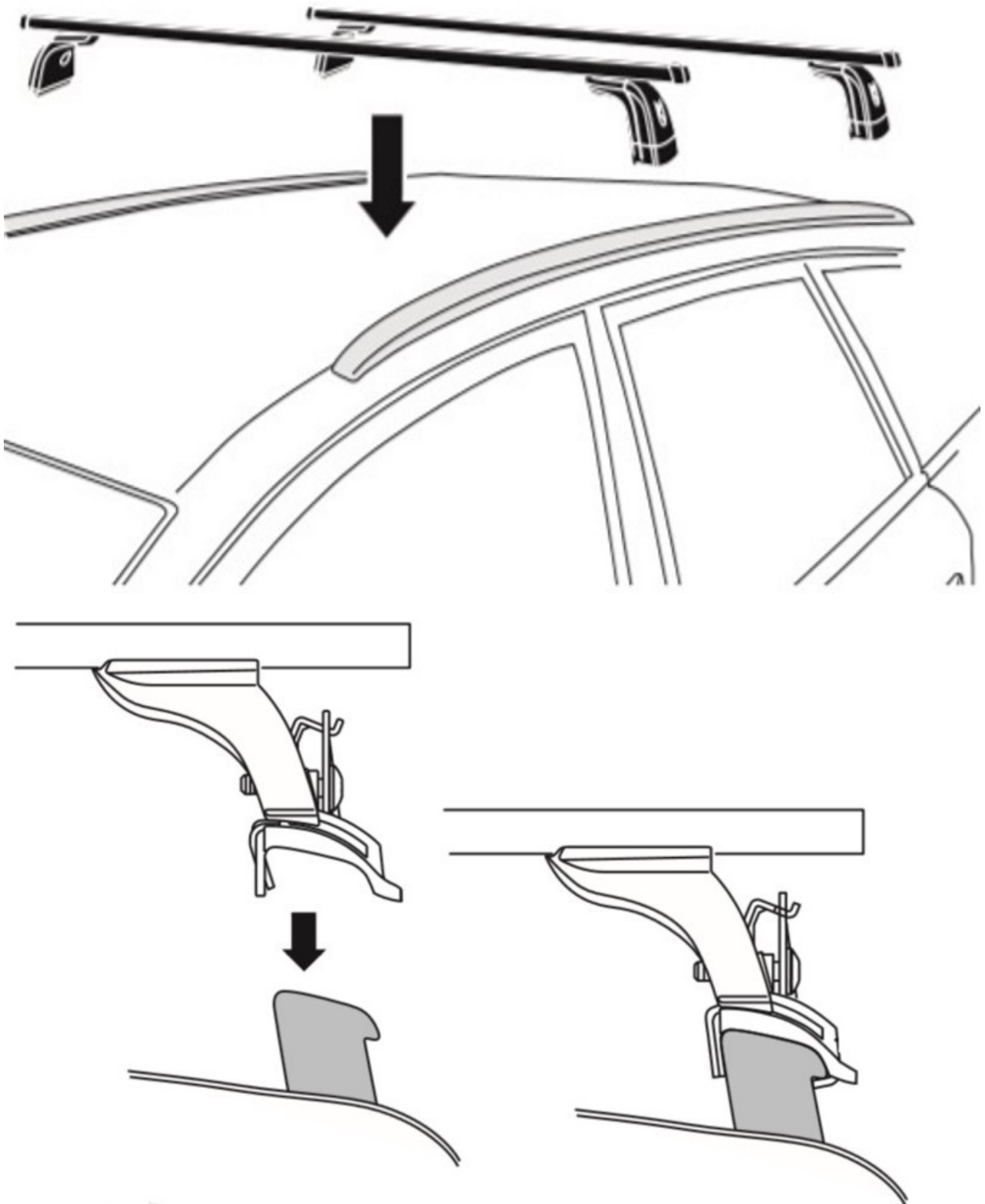

T-Track System

T-Tracks may be located within the roof itself and be flush with the roof line or may be located in a raised bar sitting on top of the roof similar to the flush bar system. What differentiates this system is the slot in the top running down the length of it. Where a mushroom shaped bolt slides in to attach the cross bar.

